



SS224-65



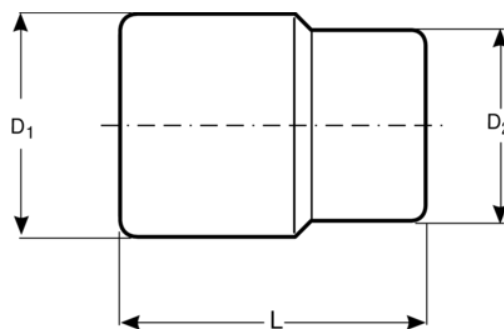

Chaves de caixa sextavadas de 3/4" em aço inoxidável

DETALHES DO PRODUTO

- Chaves de caixa de comprimento standard
- Perfil sextavado, tamanhos métricos
- Alta resistência e dureza
- Excelente resistência à corrosão
- Magnético
- Material: aço inoxidável AISI 420
- Produzido de acordo com ISO 1174-1, ISO 1171-1 e ISO 2725-1



ATRIBUTOS DO PRODUTO

Produto					
SS224-65	65 mm	80 mm	52 mm	87 mm	850 g

Follow the Fish!

