



BE1SP Spark plug wrench





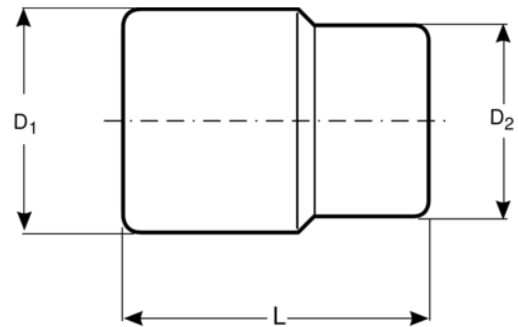

PRODUCT DETAILS

- Spark plug wrenches used to fit or remove spark plugs from engines
- Internal rubber retaining system to secure spark plug
- Bi-Hex profile, metric sizes
- 3/8" square drive
- High performance steel
- Matt chrome plated finish



PRODUCT ATTRIBUTES

商品				L	D1	D2	
BE1SP16L	3/8 in	16 mm	5/8 in	252 mm	20.5 mm	20.5 mm	480 g
BE1SP14L	3/8 in	14 mm	9/16 in	252 mm	18 mm	18 mm	345 g

