

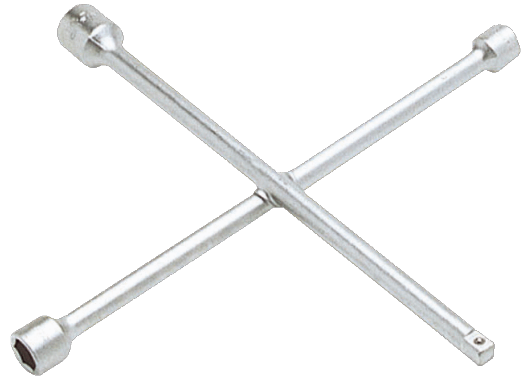

29-B/BWXW1/BWXW2 Wheel wrenches



PRODUCT DETAILS



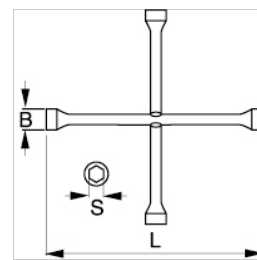

- Heavy duty four-way wheel wrenches
- Different models with different dimensions and for different application
- High performance alloy steel
- Hardness: 43-48 HRC
- Chrome plated finish
- Compliant with
- ISO 6788
- DIN 3119
- UNE 16518



Follow the Fish!



PRODUCT ATTRIBUTES

商品	S	B	L					
29-B	17,19,21 mm	25, 27, 30 mm	408 mm	1/2"	408 mm	30 mm	410 mm	1.32 kg
BWXW1	17,19,22 mm	26,28,31 mm	380 mm	1/2"	380 mm	31 mm	380 mm	6.2 kg
BWXW2	24,27,32 mm	36,40,45 mm	695 mm	3/4"	695 mm	45 mm	695 mm	4.56 kg
BWXW3	17, 19, 21, 22 mm	25, 27, 29, 31 mm	378 mm	-	378 mm	30 mm	378 mm	1.27 kg
BWXW4	24, 27, 32, 38 mm	35, 40, 46, 52 mm	695 mm	-	695 mm	52 mm	695 mm	4.71 kg

