



## BWTSP Twist socket



### PRODUCT DETAILS

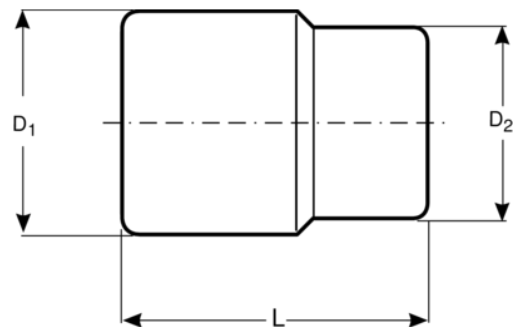

- Wheel twist sockets designed for removing damaged nuts and bolts, and especially for locking wheel nuts
- The special spiral profile on the inside enables the socket to grip sufficiently for loosening in cases where standard sockets and wrenches fail
- Drive: 3/8" or 1/2", depending on the profile dimension
- Black phosphate finish
- High performance alloy steel
- Hardness: 45-48 HRC
- Not suitable for machine operation
- 17 available dimensions
- Sold individually



Follow the Fish!



## PRODUCT ATTRIBUTES

Product			D1	D2	L	
<b>BWTSP1608</b>	8 mm	3/8 in	12 mm	17 mm	32 mm	25 g
<b>BWTSP1610</b>	10 mm	3/8 in	15 mm	17 mm	32 mm	25 g
<b>BWTSP1611</b>	11 mm	3/8 in	16 mm	17 mm	32 mm	25 g
<b>BWTSP1612</b>	12 mm	3/8 in	18 mm	18 mm	32 mm	35 g
<b>BWTSP1613</b>	13 mm	3/8 in	19 mm	21 mm	32 mm	55 g
<b>BWTSP1614</b>	14 mm	3/8 in	20 mm	21 mm	32 mm	45 g
<b>BWTSP1616</b>	16 mm	3/8 in	22 mm	22 mm	32 mm	45 g
<b>BWTSP1617</b>	17 mm	3/8 in	25 mm	24 mm	32 mm	65 g
<b>BWTSP1618</b>	18 mm	3/8 in	25 mm	26 mm	34 mm	85 g
<b>BWTSP1619</b>	19 mm	3/8 in	26 mm	26 mm	34 mm	85 g
<b>BWTSP1621</b>	21 mm	1/2 in	30 mm	27 mm	34 mm	75 g
<b>BWTSP1622</b>	22 mm	1/2 in	32 mm	27 mm	34 mm	95 g
<b>BWTSP1624</b>	24 mm	1/2 in	33 mm	26 mm	34 mm	105 g
<b>BWTSP1627</b>	27 mm	1/2 in	37 mm	27 mm	34 mm	105 g
<b>BWTSP732</b>	32 mm	1/2 in	30 mm	42 mm	38 mm	165 g
<b>BWTSP736</b>	36 mm	3/4 in	38 mm	49 mm	48 mm	305 g
<b>BWTSP741</b>	41 mm	3/4 in	38 mm	55 mm	48 mm	325 g

Follow the Fish!

