



## BWTSP Twist socket



### PRODUCT DETAILS

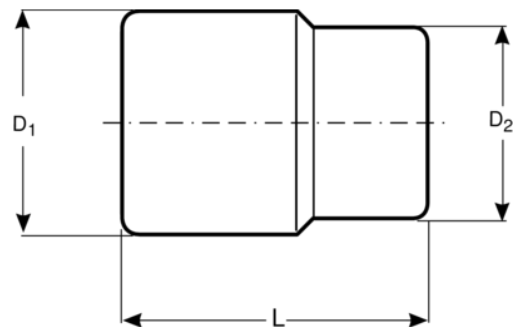

- Wheel twist sockets designed for removing damaged nuts and bolts, and especially for locking wheel nuts
- The special spiral profile on the inside enables the socket to grip sufficiently for loosening in cases where standard sockets and wrenches fail
- Drive: 3/8" or 1/2", depending on the profile dimension
- Black phosphate finish
- High performance alloy steel
- Hardness: 45-48 HRC
- Not suitable for machine operation
- 17 available dimensions
- Sold individually



Follow the Fish!



## PRODUCT ATTRIBUTES

| Product          |  |  | D1    | D2    | L     |  |
|------------------|---|---|-------|-------|-------|---|
| <b>BWTSP1608</b> | 8 mm  | 3/8 in  | 12 mm | 17 mm | 32 mm | 25 g  |
| <b>BWTSP1610</b> | 10 mm   | 3/8 in  | 15 mm | 17 mm | 32 mm | 25 g  |
| <b>BWTSP1611</b> | 11 mm   | 3/8 in  | 16 mm | 17 mm | 32 mm | 25 g  |
| <b>BWTSP1612</b> | 12 mm   | 3/8 in  | 18 mm | 18 mm | 32 mm | 35 g  |
| <b>BWTSP1613</b> | 13 mm   | 3/8 in  | 19 mm | 21 mm | 32 mm | 55 g  |
| <b>BWTSP1614</b> | 14 mm   | 3/8 in  | 20 mm | 21 mm | 32 mm | 45 g  |
| <b>BWTSP1616</b> | 16 mm   | 3/8 in  | 22 mm | 22 mm | 32 mm | 45 g  |
| <b>BWTSP1617</b> | 17 mm   | 3/8 in  | 25 mm | 24 mm | 32 mm | 65 g  |
| <b>BWTSP1618</b> | 18 mm   | 3/8 in  | 25 mm | 26 mm | 34 mm | 85 g  |
| <b>BWTSP1619</b> | 19 mm   | 3/8 in  | 26 mm | 26 mm | 34 mm | 85 g  |
| <b>BWTSP1621</b> | 21 mm   | 1/2 in  | 30 mm | 27 mm | 34 mm | 75 g  |
| <b>BWTSP1622</b> | 22 mm   | 1/2 in  | 32 mm | 27 mm | 34 mm | 95 g  |
| <b>BWTSP1624</b> | 24 mm   | 1/2 in  | 33 mm | 26 mm | 34 mm | 105 g   |
| <b>BWTSP1627</b> | 27 mm   | 1/2 in  | 37 mm | 27 mm | 34 mm | 105 g   |
| <b>BWTSP732</b>  | 32 mm   | 1/2 in  | 30 mm | 42 mm | 38 mm | 165 g   |
| <b>BWTSP736</b>  | 36 mm   | 3/4 in  | 38 mm | 49 mm | 48 mm | 305 g   |
| <b>BWTSP741</b>  | 41 mm   | 3/4 in  | 38 mm | 55 mm | 48 mm | 325 g   |

