

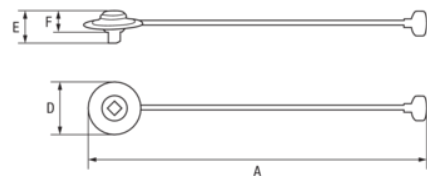



**7851-M/8951-M**  
**Angle Meter with Magnet**

PRODUCT DETAILS

- Allows any torque wrench or standard tool to measure the angle
- Angle units in degrees
- It can be used CW and ACW
- Continuous visual signal on dial
- Available with 1/2" and 3/4" square drives
- Flexible arm and magnetic fixing



PRODUCT ATTRIBUTES

Product		<b>A</b>	<b>D</b>	<b>E</b>	<b>F</b>	
<b>7851-M</b>	1/2 in	490 mm	80 mm	40 mm	30 mm	0.370 kg
<b>8951-M</b>	3/4 in	490 mm	80 mm	40 mm	30 mm	0.550 kg

Follow the Fish!

