



BE1310P425



PRODUKTOPLYSNINGER



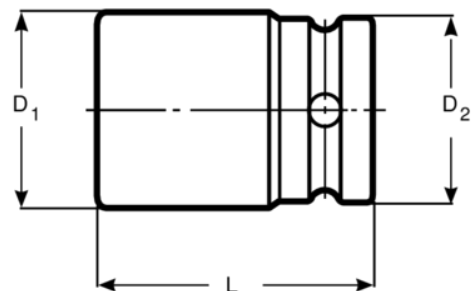

- Lige-kærvtoppe til montering/afmontering af Bosch- og Siemens-indsprøjtningssdyser
- 4 sekskantstørrelser: 25 mm, 27 mm, 29 mm og 30 mm
- BE1310P425 (25 mm) til Ford, PSA, Toyota
- BE1310P427 (27 mm) til 2.0 HDI-motorer
- BE1310P429 (29 mm) til Fiat 1.3 Multijet og Mercedes klasse A & B
- BE1310P430 (30 mm) til CDI- og HDI-motorer
- 1/2" indvendig firkant
- Højlegeret stål
- Forpakning



Follow the Fish!



PRODUKTATTRIBUTTER

Produkt				D1	D2	
BE1310P425	25 mm	1/2 in	25 mm	100 mm	30 mm	365 g

