

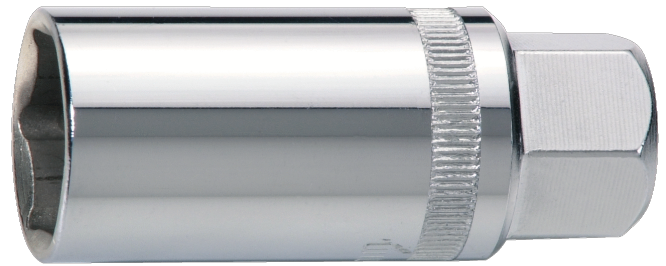

7406ZZ

**Zündkerzen-Steckschlüssel-Einsätze,
magnetisch, 3/8"**





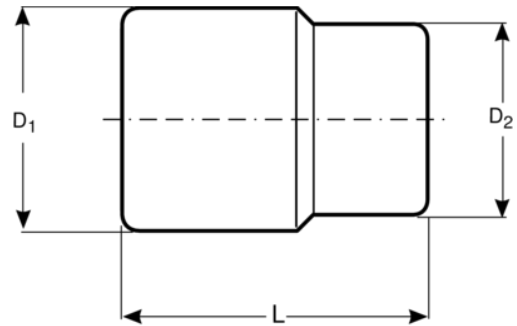

PRODUKTDDETAILS

- Zündkerzen-Steckschlüssel-Einsätze zum Ein- und Ausbau von Zündkerzen in/aus Motoren | Mit Messing-Haltevorrichtung und Permanentmagnet zum Sichern der Zündkerze | 3/8" Antrieb mit Sechskant Ansatz | DIN 3120 | ISO 1174
- Chrom-Vanadium-Stahl | Vernickelt und verchromt



PRODUKTEIGENSCHAFTEN

Produkt				L	D1	D2	
7406ZZ-16	16 mm	5/8 in	3/8	65 mm	21 mm	19 mm	95 g
7406ZZ-21	21 mm	13/16 in	3/8	68 mm	27 mm	21 mm	145 g

Follow the Fish!

