

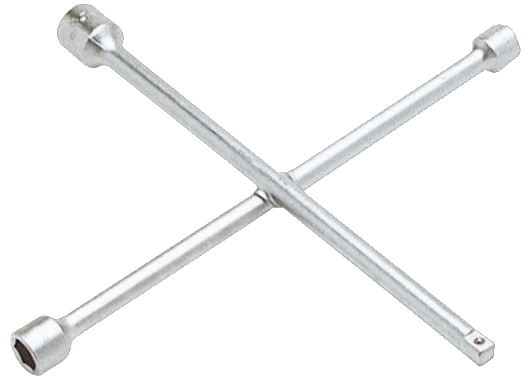

BWXW1

Clé en croix à 4 branches



DÉTAILS SUR LE PRODUIT



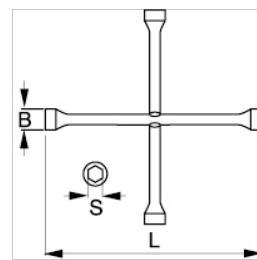

- Clés en croix à 4 branches pour usage intensif
- Différents modèles de différentes dimensions et pour différentes applications
- Alliage d'acier hautes performances
- Dureté : 43-48 HRC
- Finition chromé
- Conformes aux normes
- ISO 6788
- DIN 3119
- UNE 16518



Follow the Fish!



ATTRIBUTS DU PRODUIT

Produit	S	B	L					
BWXW1	17,19,22 mm	26,28,31 mm	380 mm	1/2"	380 mm	31 mm	380 mm	6.2 kg

Follow the Fish!

