



**4651**

## SDS+ Drill Bits 4-cutter for Reinforced Concrete

### PRODUCT DETAILS

- Immediate centring tip prevents skidding on smooth surfaces
- Size range 5 mm to 32 mm
- Optimised 4 x 90° symmetry makes all 4 carbide cutting edges work evenly and at the same time
- To withstand wear the drills are made of high-alloy steel produced with optimised hardening temperature
- For masonry, reinforced concrete, natural stone, artificial stone
- Specially designed head geometry for better centre drilling, faster drilling progress, precise drilling hole
- Fits directly into all hammer drilling machines with SDS-plus and HILTI TE-C drive
- Carbide Tipped 4-cutter with SDS+ connection
- Canal flute provides effective dust removal for increased endurance and reduced heat friction

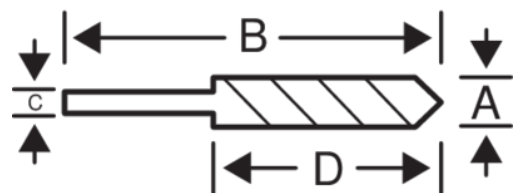

**Follow the Fish!**



# PRODUCT ATTRIBUTES

Product	A	B	C	D	 g
4651-10-1000	10.0 mm	1000 mm	SDS+ mm	940 mm	340 g
4651-10-110	10.0 mm	115 mm	SDS+ mm	50 mm	62 g
4651-10-160	10.0 mm	165 mm	SDS+ mm	100 mm	75 g
4651-10-210	10.0 mm	215 mm	SDS+ mm	150 mm	91 g
4651-10-260	10.0 mm	265 mm	SDS+ mm	200 mm	110 g
4651-10-310	10.0 mm	315 mm	SDS+ mm	250 mm	130 g
4651-10-450	10.0 mm	455 mm	SDS+ mm	390 mm	175 g
4651-10-600	10.0 mm	600 mm	SDS+ mm	540 mm	225 g
4651-12-1000	12.0 mm	1000 mm	SDS+ mm	950 mm	455 g
4651-12-160	12.0 mm	160 mm	SDS+ mm	110 mm	94 g
4651-12-210	12.0 mm	210 mm	SDS+ mm	160 mm	115 g
4651-12-260	12.0 mm	260 mm	SDS+ mm	210 mm	140 g
4651-12-310	12.0 mm	310 mm	SDS+ mm	260 mm	165 g
4651-12-450	12.0 mm	450 mm	SDS+ mm	400 mm	220 g
4651-12-600	12.0 mm	600 mm	SDS+ mm	550 mm	300 g
4651-14-1000	14.0 mm	1000 mm	SDS+ mm	950 mm	555 g
4651-14-160	14.0 mm	160 mm	SDS+ mm	110 mm	105 g
4651-14-210	14.0 mm	210 mm	SDS+ mm	160 mm	130 g
4651-14-260	14.0 mm	260 mm	SDS+ mm	210 mm	155 g
4651-14-310	14.0 mm	310 mm	SDS+ mm	260 mm	180 g
4651-14-450	14.0 mm	450 mm	SDS+ mm	400 mm	270 g
4651-14-600	14.0 mm	600 mm	SDS+ mm	550 mm	340 g
4651-15-160	15.0 mm	160 mm	SDS+ mm	110 mm	130 g
4651-15-260	15.0 mm	260 mm	SDS+ mm	210 mm	190 g
4651-15-450	15.0 mm	450 mm	SDS+ mm	400 mm	320 g
4651-16-1000	16.0 mm	1000 mm	SDS+ mm	950 mm	670 g
4651-16-160	16.0 mm	160 mm	SDS+ mm	110 mm	120 g
4651-16-210	16.0 mm	210 mm	SDS+ mm	160 mm	155 g
4651-16-260	16.0 mm	260 mm	SDS+ mm	210 mm	190 g
4651-16-310	16.0 mm	310 mm	SDS+ mm	260 mm	225 g
4651-16-450	16.0 mm	450 mm	SDS+ mm	400 mm	315 g
4651-16-600	16.0 mm	600 mm	SDS+ mm	550 mm	415 g
4651-18-250	18.0 mm	250 mm	SDS+ mm	200 mm	255 g
4651-18-450	18.0 mm	450 mm	SDS+ mm	400 mm	465 g
4651-20-250	20.0 mm	250 mm	SDS+ mm	200 mm	295 g
4651-20-450	20.0 mm	450 mm	SDS+ mm	400 mm	540 g
4651-22-250	22.0 mm	250 mm	SDS+ mm	200 mm	345 g
4651-22-450	22.0 mm	450 mm	SDS+ mm	400 mm	645 g
4651-24-250	24.0 mm	250 mm	SDS+ mm	200 mm	400 g
4651-24-450	24.0 mm	450 mm	SDS+ mm	400 mm	740 g
4651-25-250	25.0 mm	250 mm	SDS+ mm	200 mm	425 g
4651-25-450	25.0 mm	450 mm	SDS+ mm	400 mm	790 g
4651-28-250	28.0 mm	250 mm	SDS+ mm	200 mm	555 g
4651-28-450	28.0 mm	450 mm	SDS+ mm	400 mm	1000 g
4651-30-250	30.0 mm	250 mm	SDS+ mm	200 mm	580 g
4651-30-450	30.0 mm	450 mm	SDS+ mm	400 mm	1030 g
4651-32-450	32.0 mm	450 mm	SDS+ mm	400 mm	1170 g
4651-5-160	5.0 mm	165 mm	SDS+ mm	100 mm	49 g
4651-5-210	5.0 mm	215 mm	SDS+ mm	150 mm	53 g
4651-5-260	5.0 mm	265 mm	SDS+ mm	200 mm	57 g
4651-6-110	6.0 mm	115 mm	SDS+ mm	50 mm	46 g
4651-6-160	6.0 mm	165 mm	SDS+ mm	100 mm	53 g
4651-6-210	6.0 mm	215 mm	SDS+ mm	150 mm	56 g
4651-6-260	6.0 mm	265 mm	SDS+ mm	200 mm	67 g
4651-6-310	6.0 mm	315 mm	SDS+ mm	250 mm	76 g
4651-7-110	7.0 mm	115 mm	SDS+ mm	50 mm	50 g
4651-7-160	7.0 mm	165 mm	SDS+ mm	100 mm	57 g
4651-8-110	8.0 mm	115 mm	SDS+ mm	50 mm	49 g
4651-8-160	8.0 mm	165 mm	SDS+ mm	100 mm	62 g
4651-8-210	8.0 mm	215 mm	SDS+ mm	150 mm	70 g
4651-8-260	8.0 mm	265 mm	SDS+ mm	200 mm	82 g
4651-8-310	8.0 mm	315 mm	SDS+ mm	250 mm	99 g
4651-8-460	8.0 mm	465 mm	SDS+ mm	400 mm	130 g
4651-9-160	9.0 mm	165 mm	SDS+ mm	100 mm	68 g
4651-5,5-110	5.5 mm	115 mm	SDS+ mm	50 mm	43 g
4651-5,5-160	5.5 mm	165 mm	SDS+ mm	100 mm	52 g
4651-6,5-160	6.5 mm	165 mm	SDS+ mm	100 mm	55 g
4651-6,5-210	6.5 mm	215 mm	SDS+ mm	150 mm	63 g
4651-6,5-260	6.5 mm	265 mm	SDS+ mm	200 mm	70 g
4651-6,5-310	6.5 mm	315 mm	SDS+ mm	250 mm	77 g

Follow the Fish!



Contact: [info@bahco.com](mailto:info@bahco.com) / [www.bahco.com](http://www.bahco.com)